

# Thermo

## Smart Temporal Thermometer

One Scan. 4000 measurements. Thermometer Reinvented.



### Product Description

Thermo is a temporal thermometer with 16 infrared sensors that provides a medically-approved measurement in 2 seconds while also synchronizing with a dedicated smartphone app to help manage fever episodes.

### Key features

- **High Precision** - HotSpot Sensor™ Technology: 16 infrared sensors take over 4,000 measurements to find the hottest point and deliver the most accurate result.
- **Easy-to-use & hygienic** - No more intrusive measuring. Thermo takes the body's temperature in 2 seconds and avoids contact with saliva, earwax or other body fluids. Infrared thermometers are the most sanitary way to take anyone's temperature.
- **Smart Fever Management** - Synchronizes automatically with your smartphone via Wi-Fi or Bluetooth. With the Thermo app you get instant health advice plus the ability to note symptoms and medications administered. You can then share it all with your doctor or set up reminders.
- **Medically approved** - Thermo is FDA-cleared and bears the CE mark. Contains in-app fever management advice certified by Boston Children's Hospital.

## Specifications

- Model: SCT01
- Clinical accuracy:  $\pm 0.2^{\circ}\text{C}$  ( $\pm 0.4^{\circ}\text{F}$ )
- Temperature range:  $35^{\circ}\text{C}$  -  $43.2^{\circ}\text{C}$  ( $95^{\circ}\text{F}$  -  $109.8^{\circ}\text{F}$ )
- Resolution:  $0.1^{\circ}\text{C}$  /  $0.1^{\circ}\text{F}$
- Display of rectal equivalent temperature
- Sensor: thermopile array sensor (infrared sensors)
- Operating environment (temperature/ humidity):  $10^{\circ}\text{C}$  -  $40^{\circ}\text{C}$  ( $50^{\circ}\text{F}$  -  $104^{\circ}\text{F}$ ),  $15\% \leq \text{RH} \leq 95\%$
- Storage conditions (temperature/ humidity):  $-25^{\circ}\text{C}$  to  $+55^{\circ}\text{C}$  ( $-13^{\circ}\text{F}$  to  $131^{\circ}\text{F}$ ),  $15\% \leq \text{RH} \leq 95\%$ ,
- Battery type: 2x 1.5V LR03 AAA alkaline cells
- Connectivity: Wi-Fi b/g/n 2.4 Ghz (WEP, WPA, WPA2-personal encryptions), Bluetooth Smart Ready
- Display: 20x5 LEDs matrix display
- Up to 8 user profiles
- Button and touch sensitive slider
- Size: L = 116 mm (4.57 in.) x Diam = 33.2 mm (1.31 in.)
- Weight: 75g (0.165 lbs), including batteries weight
- Package content: Withings Thermo, 2x AAA batteries (already installed), protective cap, Quick Start Guide, Instruction Manual.

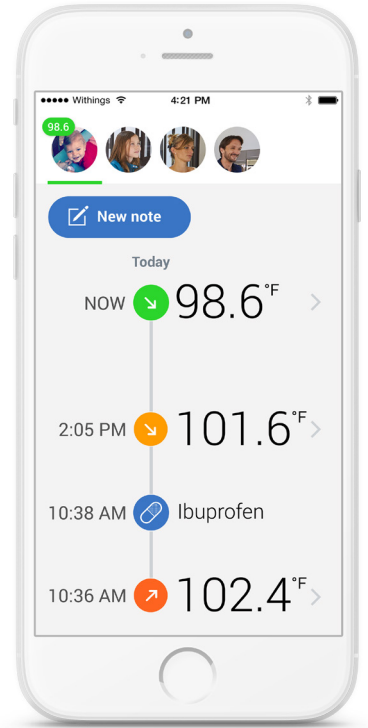

Minimum requirements  
iOS 8.0 + or Android 5.0+

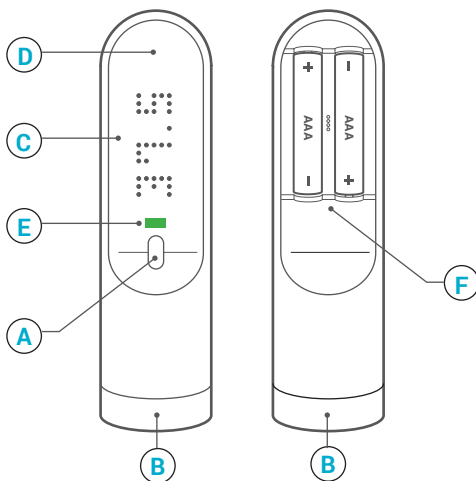

- Ⓐ Main button
- Ⓑ Sensor
- Ⓒ Screen

- Ⓓ Touch sensitive area
- Ⓔ Diagnostic LED
- Ⓕ Battery cover

## About Withings

Withings is the company that leads the connected health revolution. Our lifestyle products bring cutting edge innovation to individuals and families across the globe. Withings creates the emotional link that guarantees long-term usage and actual impact on health.

A unique range of smart products and apps for healthy and balanced choices

